



# Clamp Inserts Urethane– Soft

(248) 356-2839

*Inserts used in conjunction with SH, UH, and LH Series Clamps, are pliable to further protect sensitive utilities*

## FEATURES

- Use with Utility Clamps– **Small**, **Medium** and **Large**
- 1 pc– Slotted pliable design
- Many configurations available
- Custom designs available
- Robot Dress assistance available
- ‘Value added’ services available



## SINGLE & DUAL HOLE CONFIGURATIONS



Blank Insert  
Shown

### Small Inserts

#### Single Hole

xx = diameter in mm

SHI-Bxx

Example:

SHI-B26

Blank Insert: SHI-B00-1

#### Dual Hole

xx = diameter in mm

yy = diameter in mm

- Small hole first

SHI-Bxx/yy

Example:

SHI-B10/13



Single-Hole  
Insert Shown

### Medium Inserts

#### Single Hole

xx = diameter in mm

UHI-Bxx

Example:

UHI-B45

Blank Insert: UHI-B00-1

#### Dual Hole

xx = diameter in mm

yy = diameter in mm

- Small hole first

UHI-Bxx/yy

Example:

UHI-B34/36

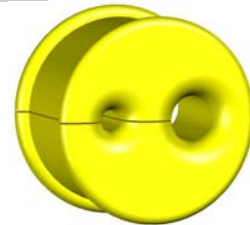

Dual-Hole  
Insert Shown

### Large Inserts

#### Single Hole

xx = diameter in mm

LHI-Bxx

Example:

LHI-B100

#### Dual Hole

xx = diameter in mm

yy = diameter in mm

- Small hole first

LHI-Bxx/yy

Example:

LHI-B34/60

Notice: The information contained herein is, to the best of our knowledge, true, accurate and reliable. Since procedures and conditions under which these products may be used are beyond our control, no warranty, expressed or implied, is made to their performance.



Syndevco Inc.  
ISO 9001:2015  
Certificate #  
1000227 QM15

## Syndevco Inc.

Sheet: 141114

24205 Telegraph Rd - Southfield MI 48033

Toll Free: (800) 356-2839 Local: (248) 356-2839 Fax: (248) 356-0928

visit us at: [www.syndevco.com](http://www.syndevco.com)



# Clamp Inserts Urethane- Soft

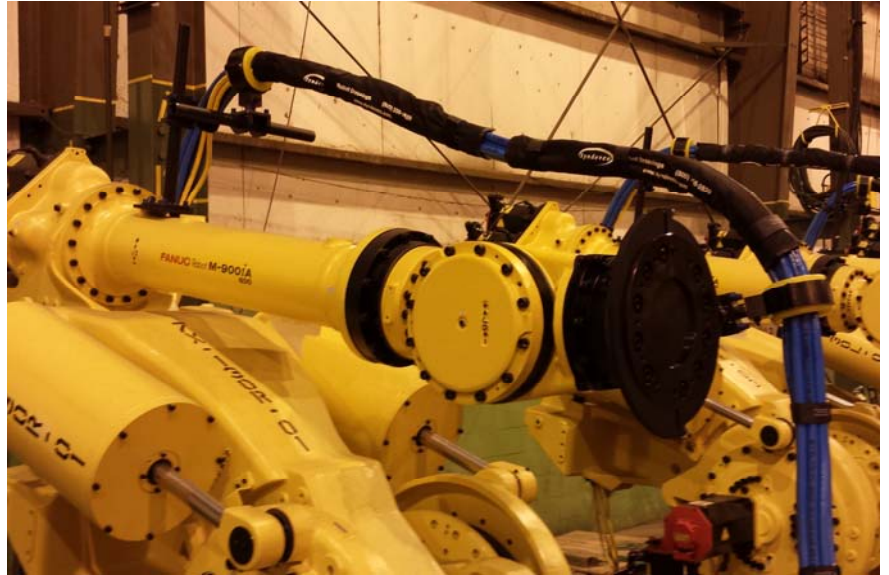

Notice: The information contained herein is, to the best of our knowledge, true, accurate and reliable. Since procedures and conditions under which these products may be used are beyond our control, no warranty, expressed or implied, is made to their performance.



Syndevco Inc.  
ISO 9001:2015  
Certificate #  
10002227 QM15

## Syndevco Inc.

24205 Telegraph Rd - Southfield MI 48033

Toll Free: (800) 356-2839 Local: (248) 356-2839 Fax: (248) 356-0928

visit us at: [www.syndevco.com](http://www.syndevco.com)